

INDUCTION TILTING BOILING KETTLE WITH STIRING DEVICE

- High quality stainless steel #304, hairline finished body construction with solid top 1.5mm thickness.
- Kettle is made with triple jacket, high efficiency, and heat insulation.
- Time and temperature control for safe and precise cooking programs
- Electric tilting with one button operation, degree of tilting more than 90°C.
- Powerful performance, high energy efficiency & quiet operation
- No open flame, no gas emission, reduces environmental pollution
- Electromagnetic heating up, thermal efficiency is over 90%.
- User friendly & easy for cleaning and no intensive maintenance required.
- Patented copper coil for powerful and uniform heat for better cooking.
- Over/under voltage/current protection
- Over heat and dry burning protection
- Soft start technology, automatic alarm device for safety operation.
- Waterproof display, anti-oil, water and, insect erosion design



- Microcomputer temperature control system, Ultra-long life magnetic sensor switch and PCB board for precise performance.
- IPX4 protection level with multiple protection
- Integrated with stirring device (mixer)

CONSTRUCTION & FEATURES

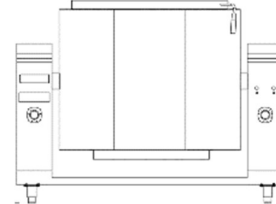
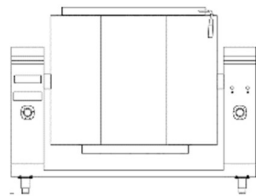

Model	TIKM-BK80	TIKM-BK100	TIKM-BK150	TIKM-BK150
Capacity (L)	80	100	150	200
Dimension (mm)	1250 x 900 x 900	1250 x 900 x 900	1500 x 900 x 900	1500 x 900 x 900
Power (kW)	15 kW	20 kW	25 kW	30 kW
Voltage	380V/50Hz,3P	380V/50Hz,3P	380V/50Hz,3P	380V/50Hz,3P

SPECIFICATIONS

Induction Boiling Kettle

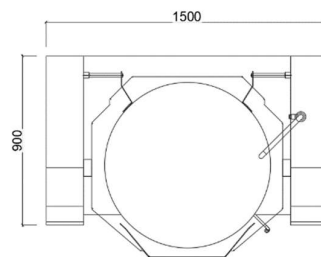
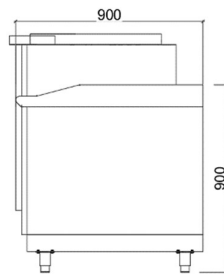
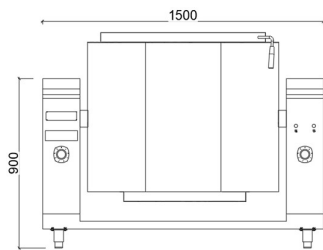
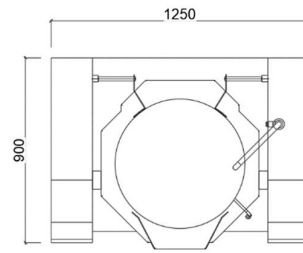
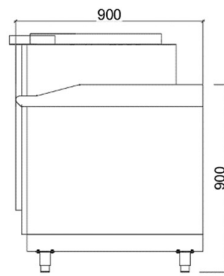
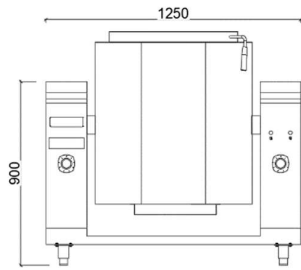

TECHNICAL DRAWINGS



m: +65-9038-0875
e: sales@trutek.sg
w: www.trutek.sg

TRUTEK PTE. LTD
470 North Bridge Road, #5-12 Bugis Cube,
Singapore (188735)